

A16.5 Light Pole Base Detail

GENERAL

Designers shall verify that all applicable portions of these standards are incorporated into the project's design, drawings, specifications and final construction. Requests for variances from these standards shall be submitted in writing to the DCM Project Manager, using the KU Standards Variance Request Form found in [Appendix A1.1](#), for review and written approval or rejection as indicated on the form.

1/2" ~ x 8'-6" long ground rod with electrolyte copper over a rigid steel core to be driven into ground.

1" Chamfer

1'-4" Lap

3/4" ~ Conduit (2 min.) each base or as called for. Cap any unused conduit for future use.

8-#6 Vertical Reinforcing Bars

4" Clear to side of pier

Anchor bolt (typ. of 4). Provide and install per pole manufacturer's requirements.

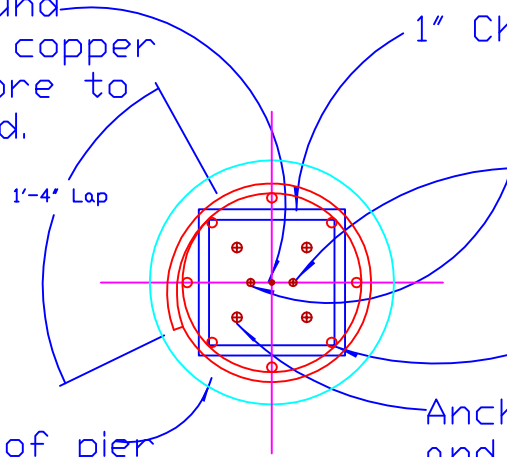

20' LIGHTPOLE BASE PLAN

NOT TO SCALE

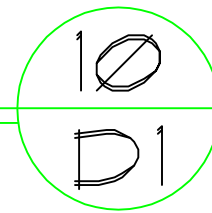

1/2" x 8'-6" long ground rod with electrolyte copper over a rigid steel core to be driven into ground.

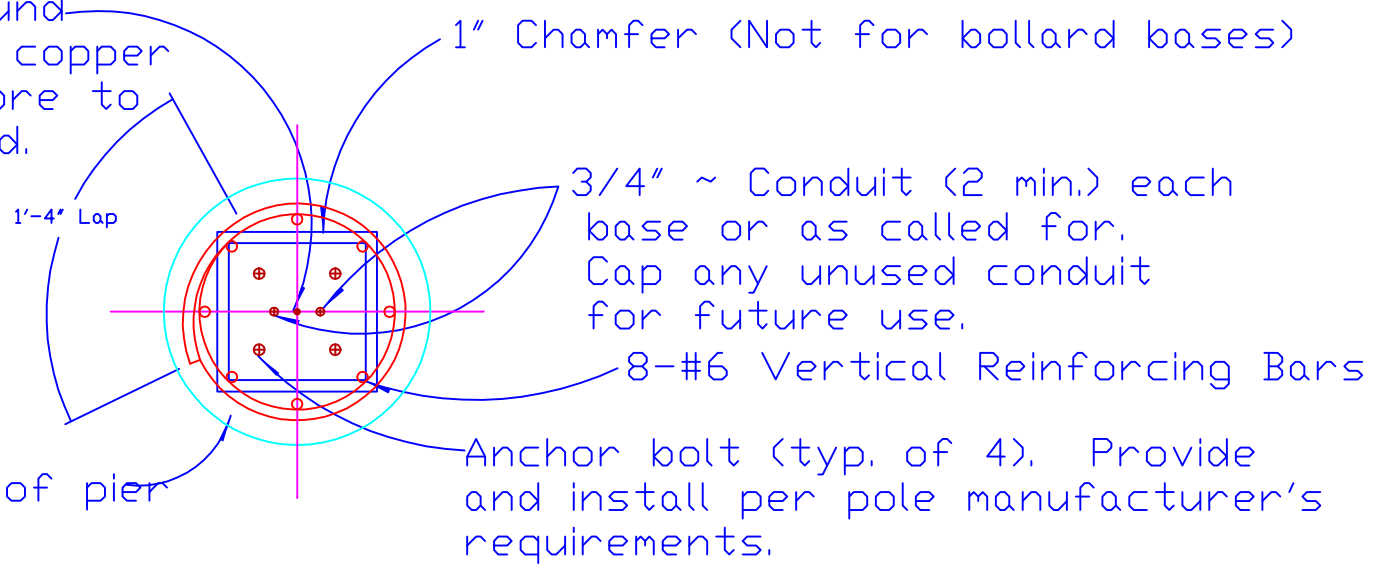

4" Clear to side of pier

30" LIGHTPOLE BASE PLAN

NOT TO SCALE

12
D1

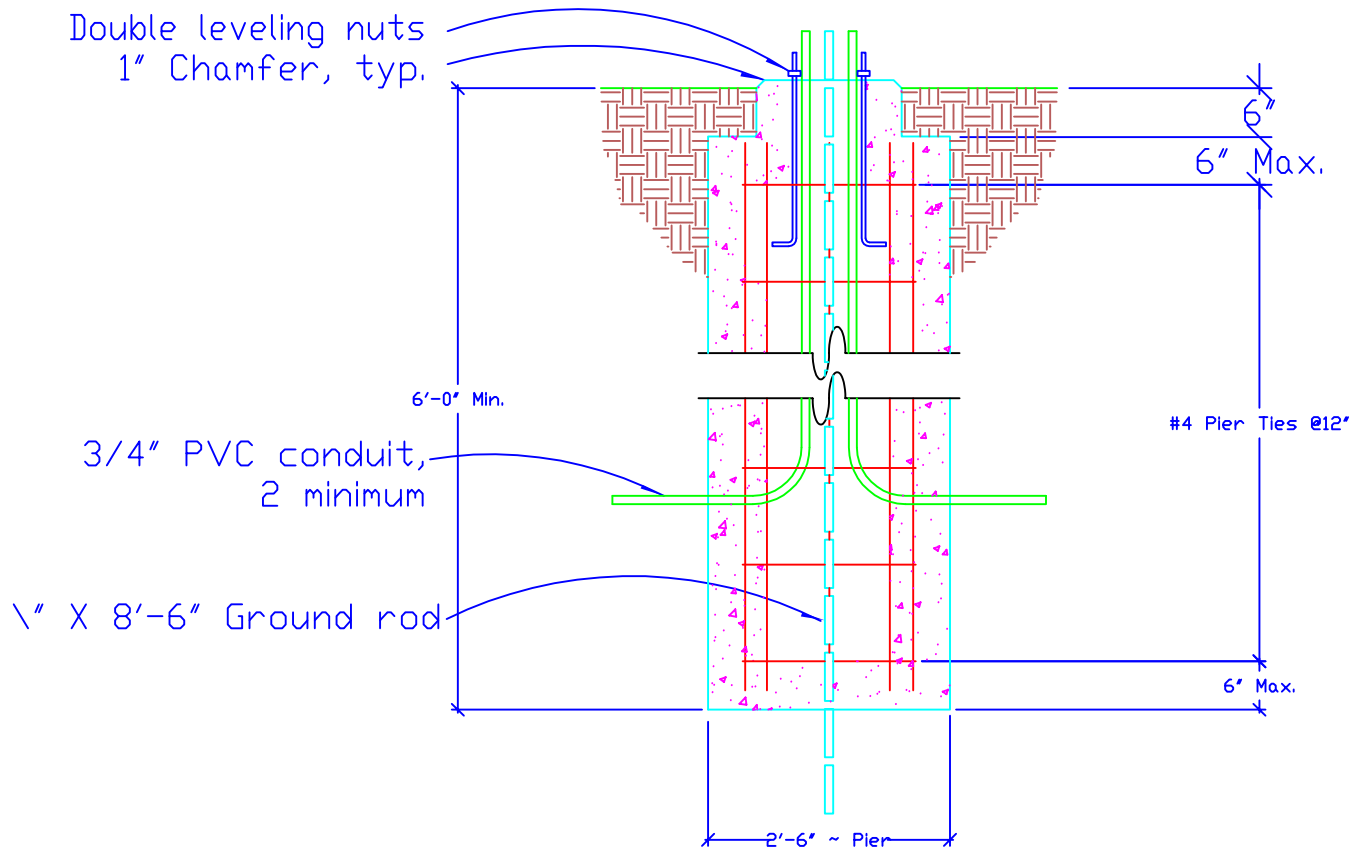

20' LIGHTPOLE BASE SECTION

NOT TO SCALE

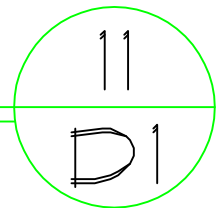

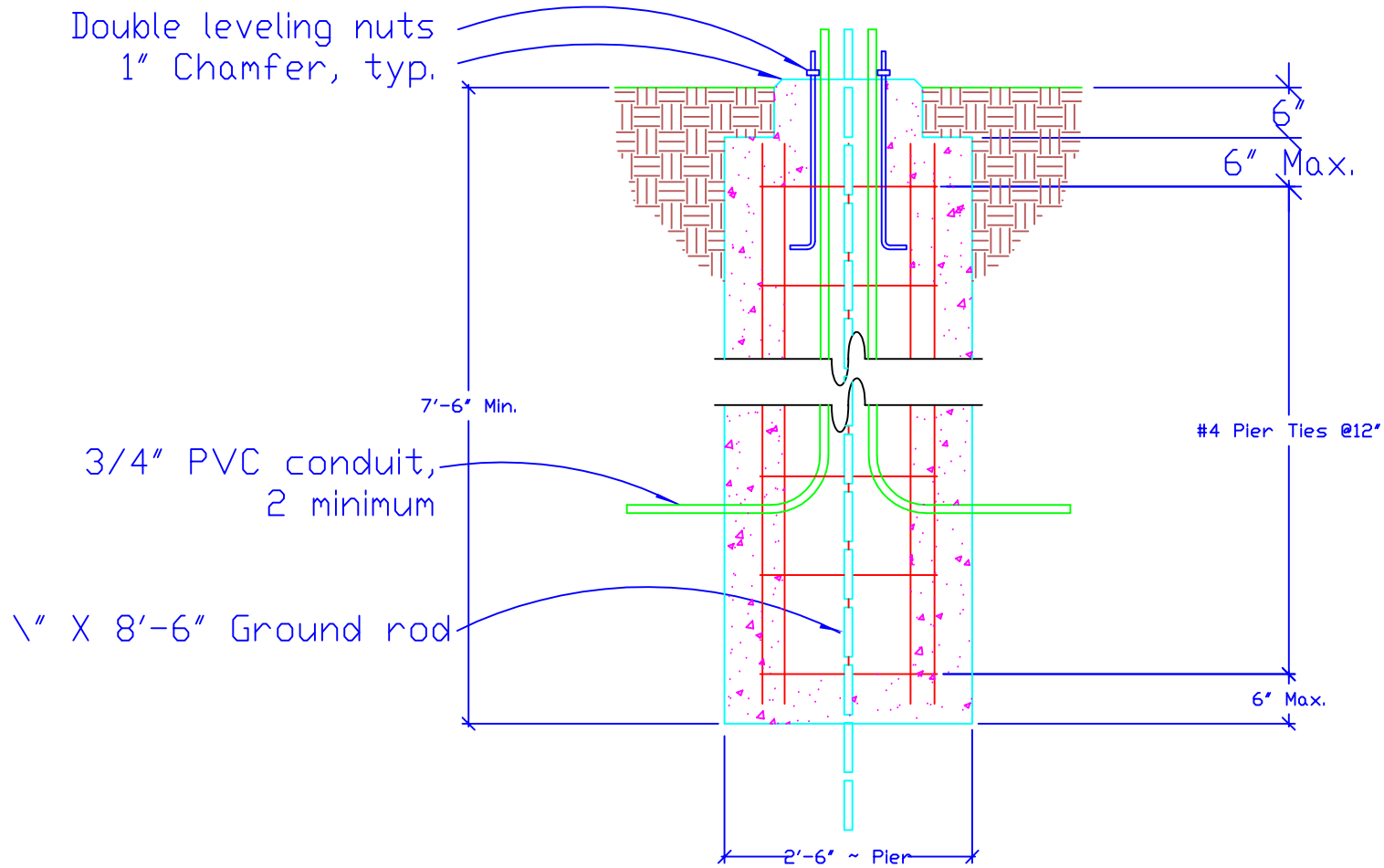

30" LIGHTPOLE BASE SECTION

NOT TO SCALE

13
D1

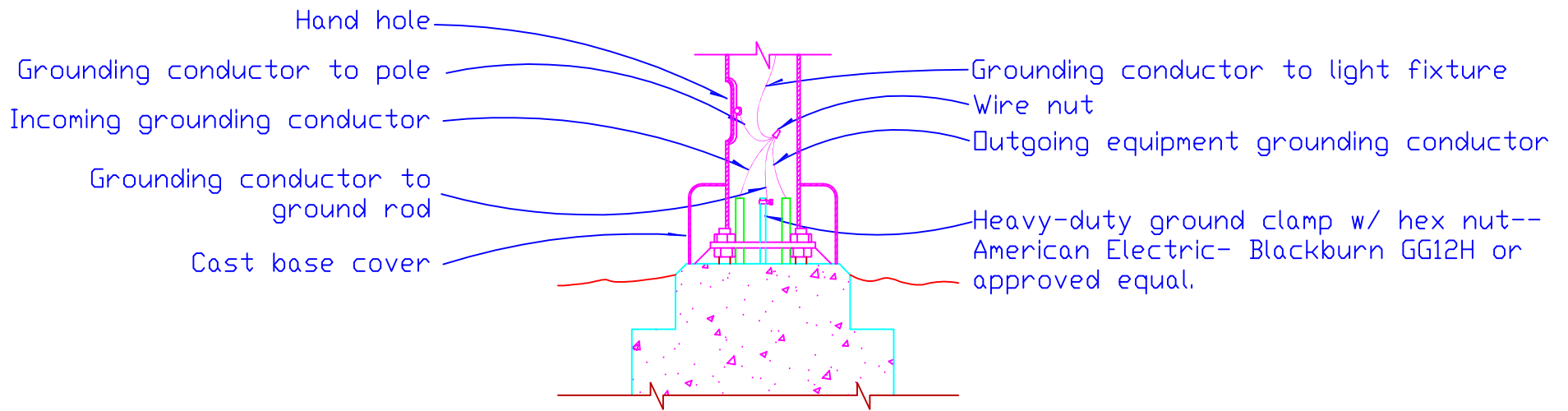

GROUNDING DETAIL

NOT TO SCALE

15
D1

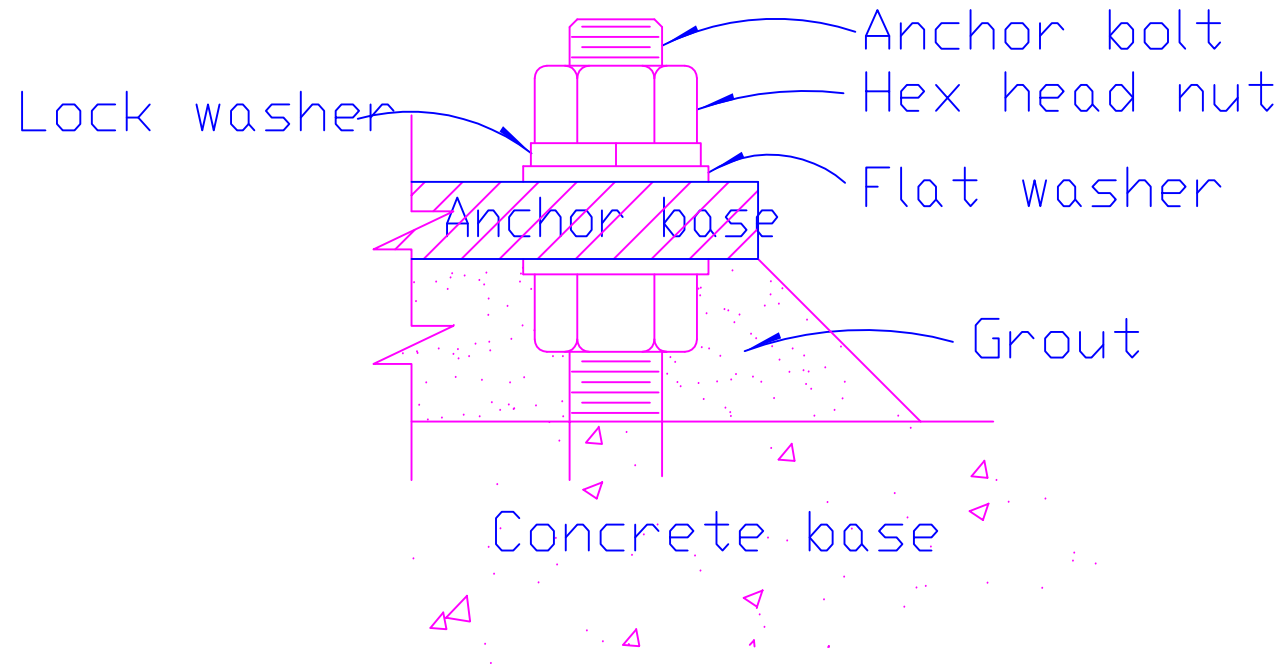

LEVELING DETAIL

NOT TO SCALE

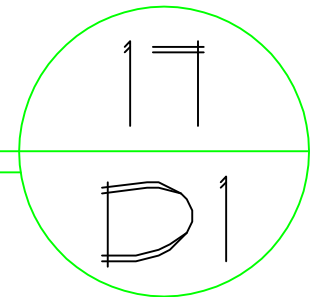

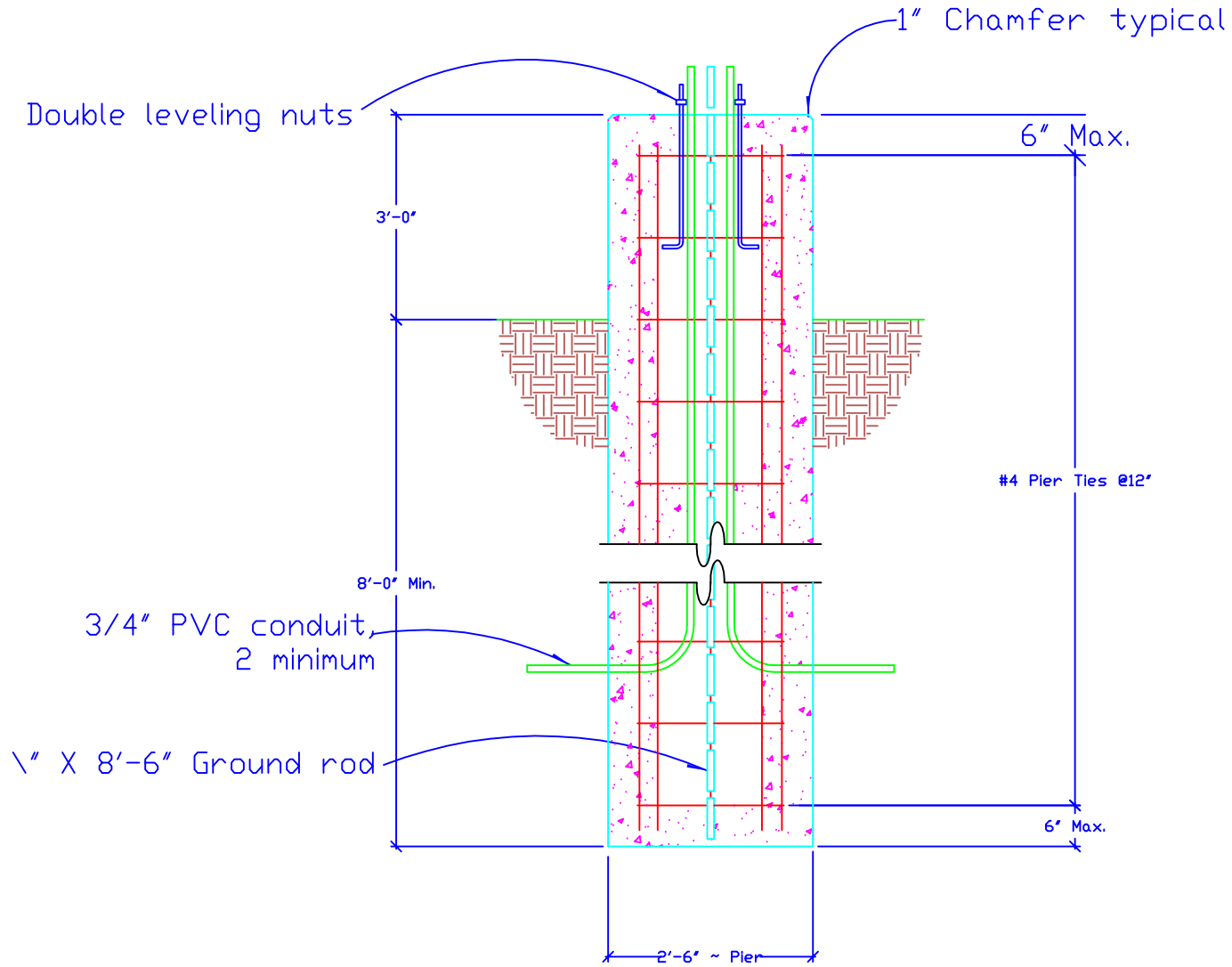

PARKING LOT DETAIL

NOT TO SCALE

16
D1

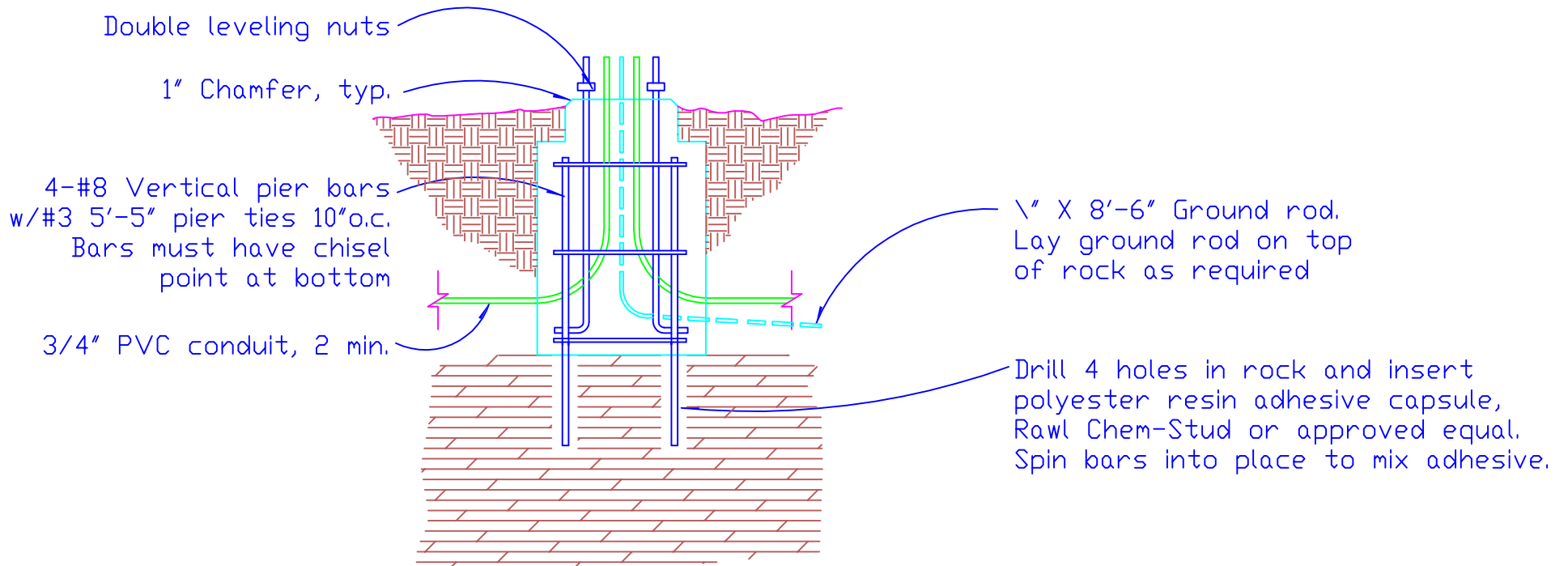

POLE FOUNDATION DETAIL

NOT TO SCALE

14
D1